

GOODMAN

RODOLFO DORDONI DESIGN

A detail that becomes volume is the essence of the Goodman design, the modular seating system by Rodolfo Dordoni. With a clear 1970s imprint, the inspiration behind this design is the graphic character of those years, its ability to stratify and cross marks, reducing the complexity of things into a few distinctive features. In this way, in Goodman the mark of the matelassé stitching, typical of Minotti's tailoring processes, draws shadows and light on the seat, creating the sensation of a quilted cross-padding.

The arrangement depicted is just one example of the many different compositions possible with our seating systems. We suggest that you contact the nearest Minotti dealer to explore the options most suited to your needs and select the upholstery of your choice from the exclusive Minotti collection.



GOODMAN - Arrangement 21

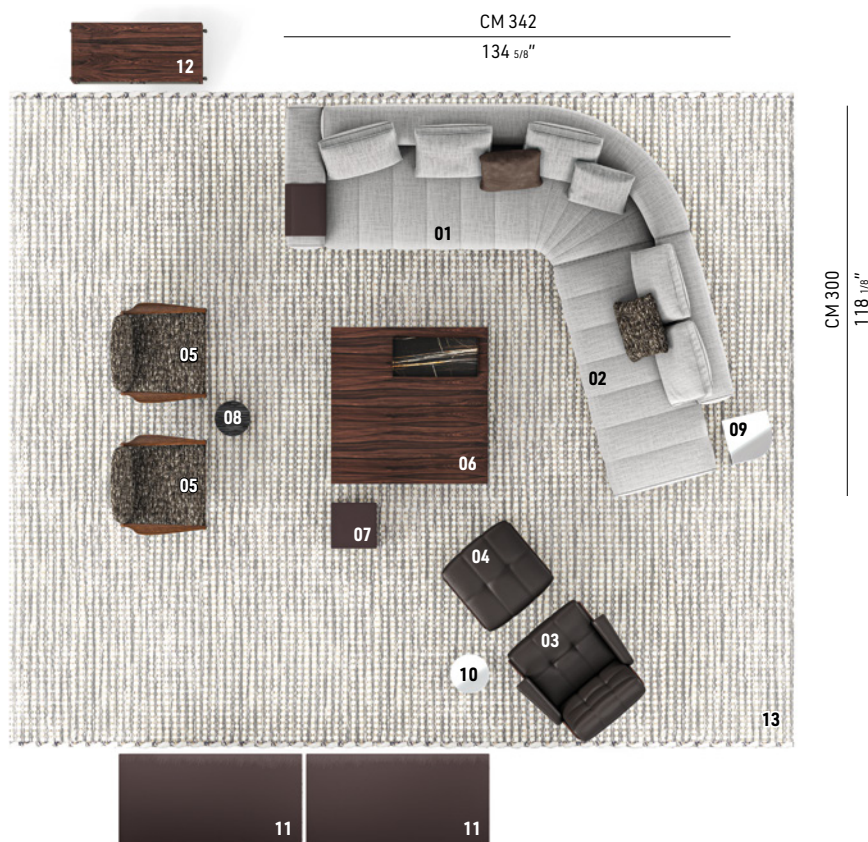

SOFA ARRANGEMENT

- 01 GOODMAN UNIT 75°**
INCLINED ELEMENT WITH 1 ARMREST SX
CM 309X124 H86
- 02 GOODMAN**
OPEN-END ELEMENT SX CM 186X110 H86
BACKREST 134

FURNISHING ACCESSORIES

- 03 DAIKI**
SWIVEL BERGÈRE CM 94X94 H93
- 04 DAIKI**
FOOTSTOOL WITH BASE CM 68X64 H40
- 05 YOKO**
ARMCHAIRS CM 77X75 H73
- 06 BOTEKO**
COFFEE TABLE CM 120X120 H30
- 07 SOLID SADDLE-HIDE**
SIDE TABLE CM 35X35 H45
- 08 PILOTIS WOOD**
SIDE TABLE Ø CM 25 H45
- 09 JAMES**
SIDE TABLE CM 35X35 H45
- 10 ANISH**
SIDE TABLE Ø CM 30 H45
- 11 SOLID**
STORAGE COFFEE TABLES WITH 1 DRAWER
CM 140X70 H42
- 12 SUPERQUADRA**
VERTICAL CABINET CM 105X45 H141
- 13 OSAKA**
RUG CM 600X500

Furnishing accessories



03
DAIKI
SWIVEL BERGÈRE CM 94X94 H93



04
DAIKI
FOOTSTOOL WITH BASE CM 68X64 H40



05
YOKO
ARMCHAIRS CM 77X75 H73



06
BOTECO
COFFEE TABLE CM 120X120 H30



07
SOLID SADDLE-HIDE
SIDE TABLE CM 35X35 H45



08
PILOTIS WOOD
SIDE TABLE Ø CM 25 H45



09
JAMES
SIDE TABLE CM 35X35 H45



10
ANISH
SIDE TABLE Ø CM 30 H45



11
SOLID
STORAGE COFFEE TABLE
WITH 1 DRAWER CM 140X70 H42



12
SUPERQUADRA
VERTICAL CABINET CM 105X45 H141



13
OSAKA
RUG CM 600X500